

Network Printing Scale

CN1



Network Printing Scale

Introducing the first product of the new CN series, CN1. CN stands for "CAS NETWORK" and is a printer scale lineup with enhanced network functionality. It features robust remote functionality based on enhanced networks and improved information transfer capability with 7" color display. Also, CN1 is compatible with the existing CL series.



CN1 SERIES

Overview



Display

7" color display
800 X 480 pixels
16.7M colors(24bit)

Body

Dark gray ABS upper case
Diecasting aluminum platter



Keyboard

Embossed key for clear touch feedback (Polydome type)
72 PLU keys & 36 function keys

Printer

Printing speed : 100mm/sec
Label size : Max. width-60mm & length-290mm

Interface

- 1) USB Port for barcode scanner, keyboard, USB memory stick
- 2) LAN for weighing network system
- 3) RJ11 for cash drawer
- 4) RS-232C for external printer, PC
- 5) Wireless LAN for Wi-Fi (optional)

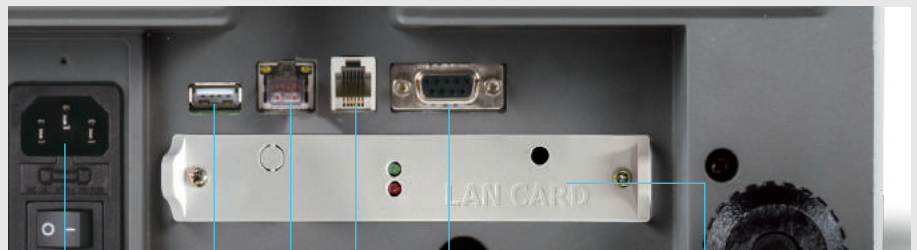

Power

USB Host

LAN

RJ11

RS-232C

Wireless LAN

Feature

Remote control & print

Via CN1 remote software, users can connect CN1 scale remotely and check status and malfunction of scale. In addition, CN1 software includes remote printing function which user can view actual CN1 printed images remotely.

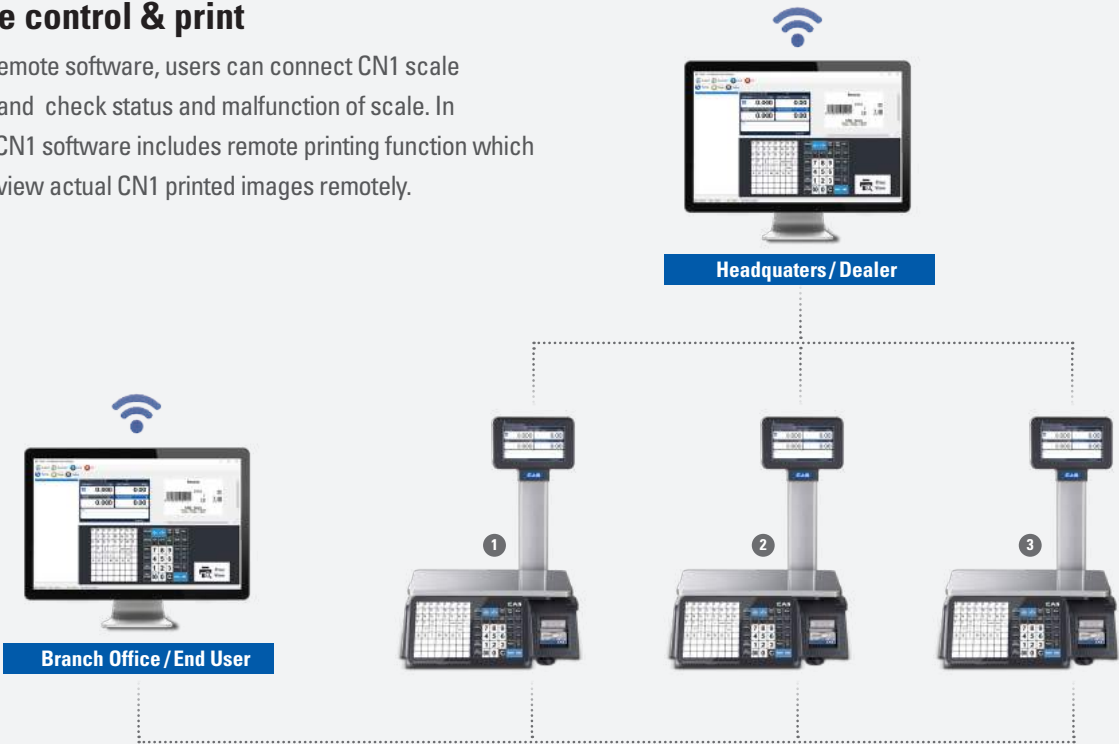

Remote firmware update via ethernet

User can update a firmware of CN1 remotely when connected to wired or wireless ethernet. Also, Firmware updates can be easily done by connecting RS-232C or USB flash drives as before.



7" vivid color display

Via 7" color display with 800X480 resolution & user-friendly UI, it is easy to check product information and weight, and operate a scale.



PLU and programmable function keys

CN1 has 72 PLU keys and 36 function keys. also, it can store up to 10,000 PLU and quickly transfer PLU data for scale to computer or computer to scale via Wi-Fi or RS-232C.



■ Specification

| MODEL | CN1 | | | |
|---------------------|--|-----------|---------------|--------------|
| Max. Capacity | 6/15 kg | 15/30 kg | 15/30 lb | 30/60 lb |
| Interval | 2/5 g | 5/10 g | 0.005/0.01 lb | 0.01/0.02 lb |
| Max. Tare | -9.998 kg | -9.995 kg | -9.995 lb | -29.99 lb |
| A/D Conversion Rate | Approx. 8 times/sec. | | | |
| Measurement Type | Load Cell | | | |
| Platter Size | 380 x 250 mm | | | |
| Key | 72 PLU keys, 36 function keys, 144 PLU | | | |
| Display | 7" color display(800 x 480) | | | |
| Printing Speed | 100 mm/sec | | | |
| Printing Resolution | 202 dpi | | | |
| Label Size | Width : 40 mm ~ 60 mm / Length : 30 mm ~ 290 mm | | | |
| Barcode Type | UPC, EAN13, I2OF5, CODE128, GS1 databar, QR code | | | |
| Printer Type | Direct thermal print | | | |
| Operating Temp. | -10°C ~ 40°C (14°F ~ 104°F) | | | |
| Power | AC 100 ~ 240V 50/60Hz 1.5A | | | |

■ Dimension

